

Movolift - general product information

Movolift

Consists of a MovoZ Z3 unit fitted with mounting frame, gearbox, three phase asynchronous brake motor and limit switches, prepared for suspension in a Movorail or Tollobelt system.

- Stroke up to 1,5 m
- Safety nut
- Lifting speed up to 0,4 m/s
- Load up to 7500 N
- Three types of frames available:
frame without rotation, frame with $\pm 360^\circ$
manual rotation and frame with $\pm 360^\circ$
motorized rotation.

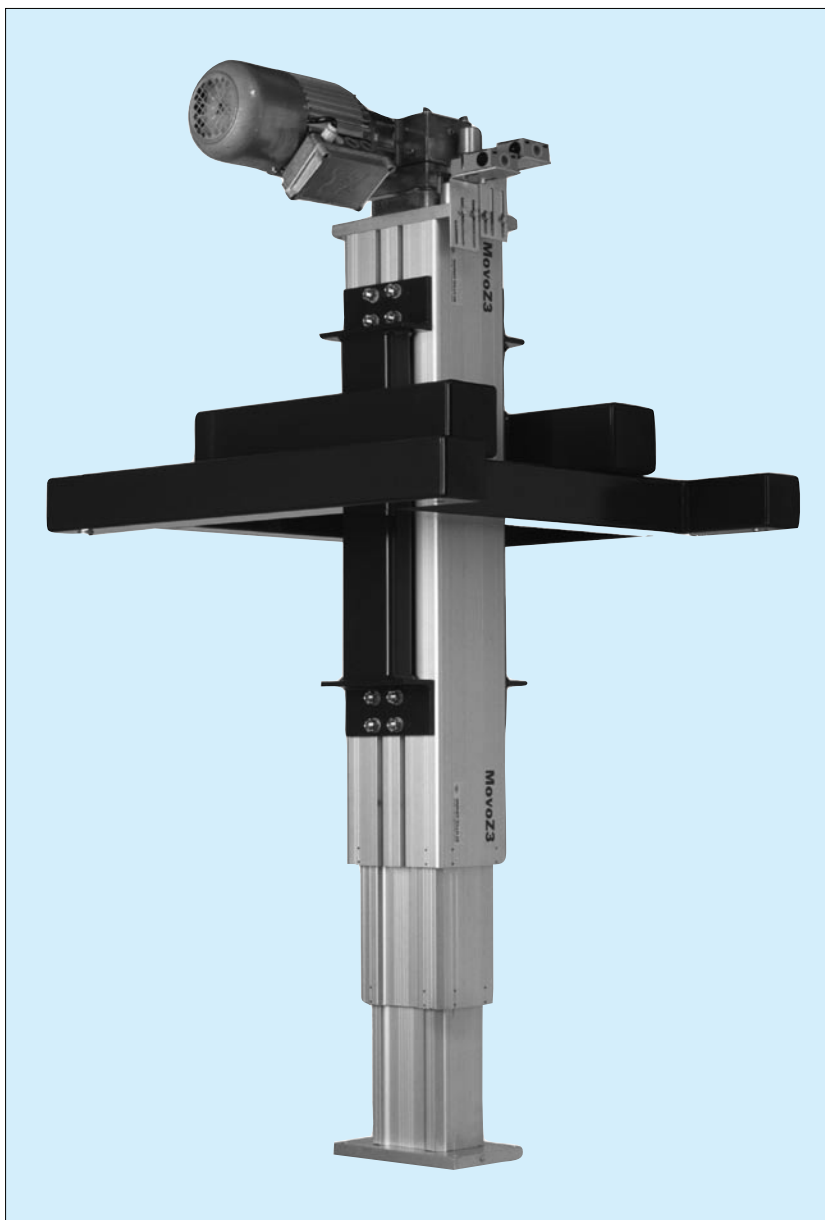
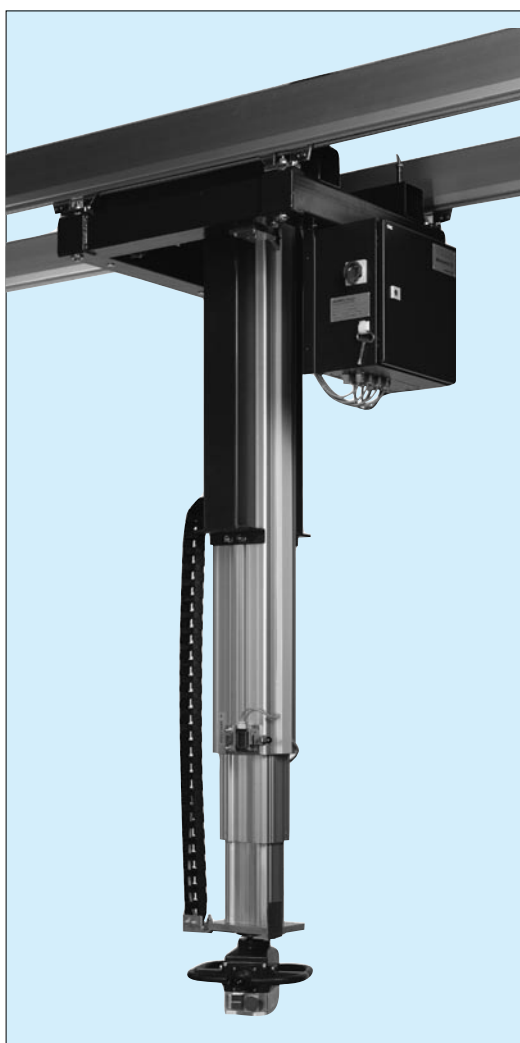

General

Parameters	MLZ31	MLZ33	MLZ35	MLZ37	MLZ39
Lifting motor	3 × 230/400 Vac 50 Hz 1,1 kW 230 Vac brake	3 × 230/400 Vac 50 Hz 1,1 kW 230 Vac brake	3 × 230/400 Vac 50 Hz 1,1 kW 230 Vac brake	3 × 230/400 Vac 50 Hz 2,2 kW 230 Vac brake	3 × 230/400 Vac 50 Hz 2,2 kW 230 Vac brake
Ambient temperature (°C)	-20 to 70	-20 to 70	-20 to 70	-20 to 70	-20 to 70
Weight without rotation, type A (kg)	140 + Max. retracted × 0,42			150 + Max. retracted × 0,44	
Weight with manual rotation, type B (kg)	235 + Max. retracted × 0,42			245 + Max. retracted × 0,44	
Weight with motorized rotation, type C (kg)	280 + Max. retracted × 0,42			290 + Max. retracted × 0,44	

Load capacity

Parameters	MLZ31	MLZ33	MLZ35	MLZ37	MLZ39
Max. lifting stroke (m)	1,5	1,5	1,5	1,5	1,5
Fz max. lifting load. (N)	5000*	2400*	1100*	7500*	3500*
Mx max. (Nm)	2000	2000	2000	2000	2000
My max. (Nm)	2000	2000	2000	2000	2000
Mz max. (Nm)	330	330	330	330	330
Max. lifting speed (m/s)	0,09	0,2	0,4	0,13	0,3

* The max. lifting capacity for any application ultimately depends on the values for Mx, My and Mz

Rotation data

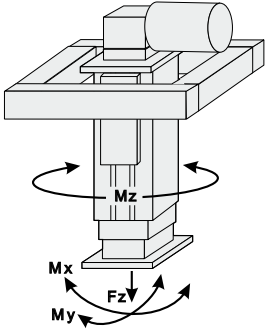
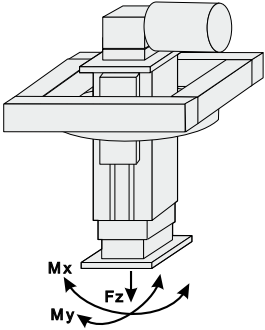
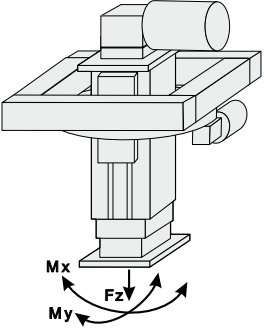
Parameters	MLZ3 · A	MLZ3 · B	MLZ3 · C
Type of rotation	none	manual ± 360°	motorized ± 360°
Rotation motor	–	–	3 × 230/400Vac 50 Hz 0,37 kW
Max. rotation speed (rpm)	–	–	10 rpm
Anti back driving mechanism	–	no	yes, self-locking
			

Dimensions

Designation: MLZ31(3/5/7/9)A

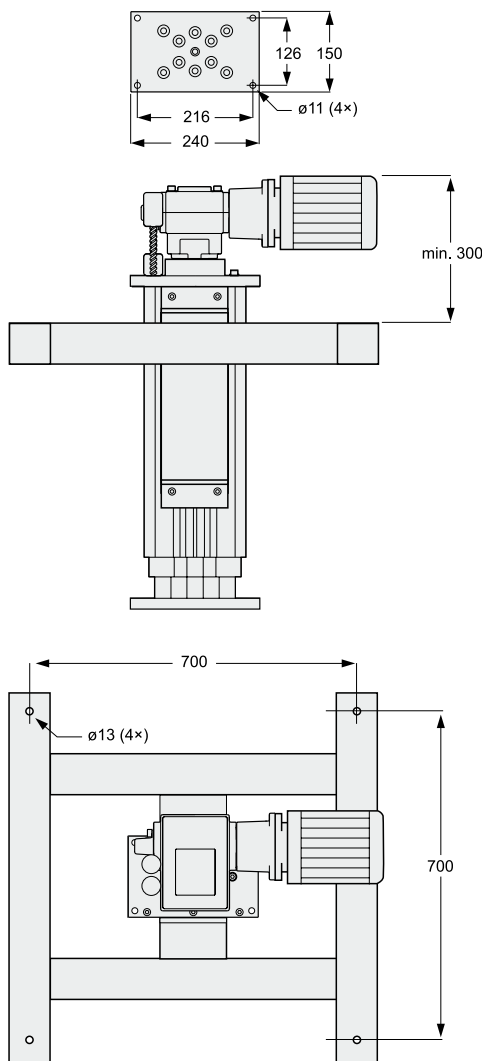

Designation: MLZ31(3/5/7/9)B(C)

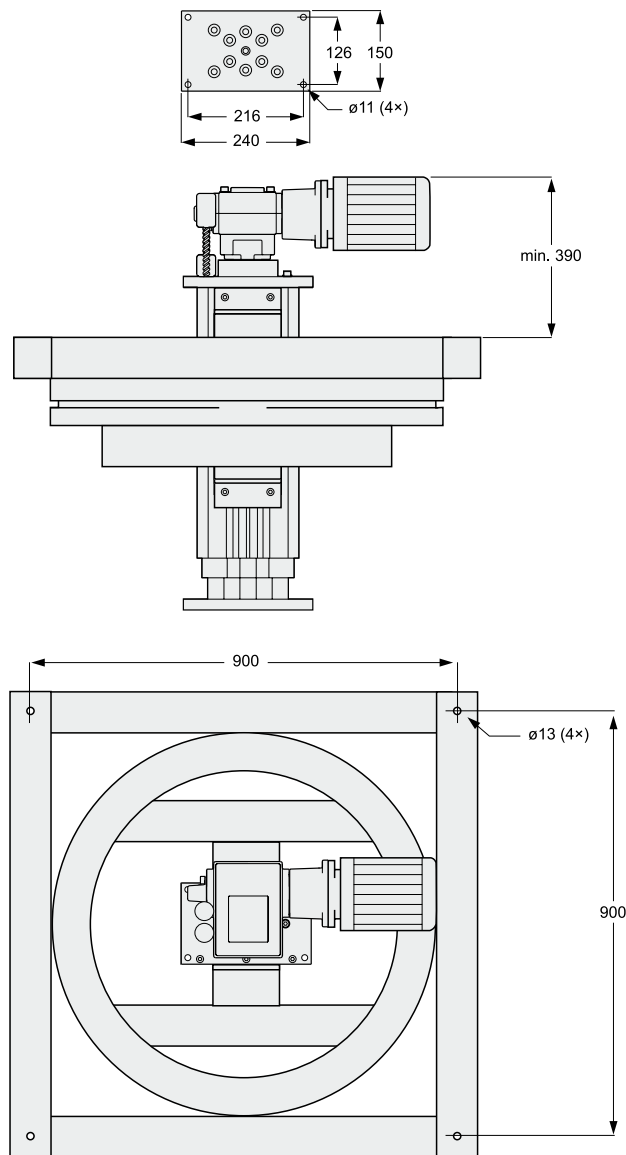

Ordering length

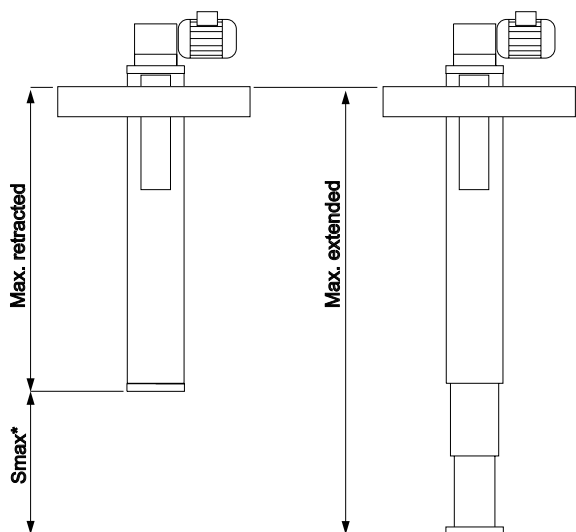

* Smax = maximum stroke between the mechanical stops of the unit (theoretical stroke). Safe stroke is normally about 100 mm shorter (practical stroke).

Designation information

Movolift

Designation example	ML	Z3	3	A	087	157
Unit type Movolift	ML					
Type of lifting unit MovoZ Z3		Z3				
Max, lifting load / max. lifting speed 5000 N / 0,09 m/s 2400 N / 0,20 m/s 1100 N / 0,40 m/s 7500 N / 0,13 m/s 3500 N / 0,30 m/s			1 3 5 7 9			
Frame type No rotation Manual rotation Motorized rotation				A B C		
Max. retracted length (min. length from the top of the frame) in cm	
Max. extended length (max. length from the top of the frame) in cm

EUROPE

United Kingdom

Thomson
Office 9, The Barns
Caddsdwn Business Park
Bideford
Devon, EX39 3BT
Phone: +44 (0) 1271 334 500
E-mail: sales.uk@thomsonlinear.com

Germany

Thomson
Nürtinger Straße 70
72649 Wolfschlügen
Phone: +49 (0) 7022 504 0
Fax: +49 (0) 7022 504 405
E-mail: sales.germany@thomsonlinear.com

France

Thomson
Phone: +33 (0) 243 50 03 30
Fax: +33 (0) 243 50 03 39
E-mail: sales.france@thomsonlinear.com

Italy

Thomson
Largo Brughetti
20030 Bovisio Masciago
Phone: +39 0362 594260
Fax: +39 0362 594263
E-mail: sales.italy@thomsonlinear.com

Spain

Thomson
E-mail: sales.esm@thomsonlinear.com

Sweden

Thomson
Estridsväg 10
29109 Kristianstad
Phone: +46 (0) 44 24 67 00
Fax: +46 (0) 44 24 40 85
E-mail: sales.scandinavia@thomsonlinear.com

SOUTH AMERICA

Brasil

Thomson
Av. Tamboré, 1077
Barueri, SP – 06460-000
Phone: +55 (11) 3616-0191
Fax: +55 (11) 3611-1982
E-mail: sales.brasil@thomsonlinear.com

USA, CANADA and MEXICO

Thomson
203A West Rock Road
Radford, VA 24141, USA
Phone: 1-540-633-3549
Fax: 1-540-633-0294
E-mail: thomson@thomsonlinear.com
Literature: literature.thomsonlinear.com

ASIA

Asia Pacific

Thomson
E-mail: sales.apac@thomsonlinear.com

China

Thomson
Rm 2205, Scitech Tower
22 Jianguomen Wai Street
Beijing 100004
Phone: +86 400 6661 802
Fax: +86 10 6515 0263
E-mail: sales.china@thomsonlinear.com

India

Thomson
c/o Fluke Technologies Pvt. Ltd.
#424, Deodhar Center,
Marol Maroshi Road,
Andheri – E, Mumbai – 400059 India
Phone: +91 22 29207641
E-mail: sales.india@thomsonlinear.com

Japan

Thomson
Minami-Kaneden 2-12-23, Suita
Osaka 564-0044 Japan
Phone: +81-6-6386-8001
Fax: +81-6-6386-5022
E-mail: csjapan@scgap.com

Korea

Thomson
F7 Ilsong Bldg, 157-37
Samsung-dong, Kangnam-gu,
Seoul, Korea (135-090)
Phone: +82 2 6917 5049
Fax: +82 2 528 1456
E-mail: sales.korea@thomsonlinear.com

www.thomsonlinear.com

200607-02 0706 ENG | 2006 | 20160701SK

Errors and technical alterations reserved. It is the responsibility of the product user to determine the suitability of this product for a specific application. All trademarks property of their respective owners. © Thomson Industries, Inc. 2016

 **THOMSON**®

Linear Motion. Optimized.™